



OCEANWORLD
YACHTS

...PEARL | 100
HYBRID



NEW PEARL 100 HYBRID MAIN FEATURES



- RINA Classification Pleasure Type A (Hull and machinery)
- Twin MAN 2000 engines
- E-Motion hybrid system
- Raised Pilot House
- 5 guest cabins, including 2 master suites, large forward VIP, and 2 twin cabins
- Direct access from main deck master cabin to foredeck
- Crew accommodation for 4/5 with direct engine room access
- Garage capacity for Williams 445DJ and Sea-Doo Spark
- Spacious aft cockpit with fold-out wings
- Spacious flybridge deck with direct access to foredeck
- Interior design by Kelly Hoppen interiors with choice of styles
- Exterior design and naval architecture by Dixon Yacht Design
- 5 year Warranty



E X T E R I O R













I N T E R I O R



SALOON





MAIN DECK MASTER



MID SHIPS MASTER



VIP CABIN



TWIN CABIN



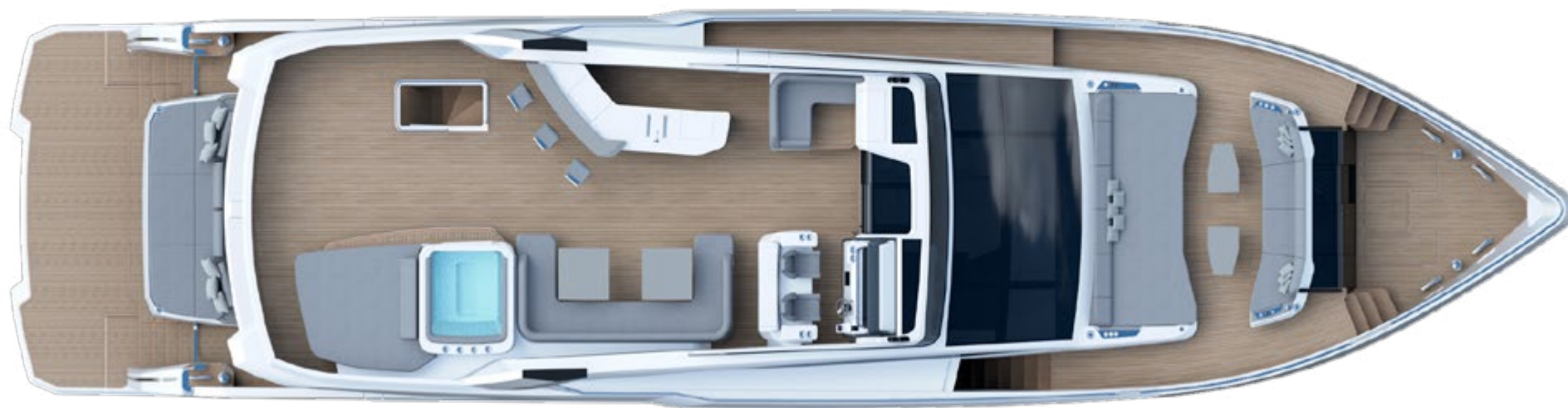

DIMENSIONS

Overall Lenght	96'6"	29.43m
Beam	22'1"	6.75m
Draft	6'10"	2.08m
Fuel capacity	2747 US gallons	10400 litres
Water capacity	475.5 US gallons	1800 litres
Displacement		102 tonnes
RINA Classification Pleasure	Type A	

POWER

Marine Diesel Engines	2 x MAN 2000HP 1471 Kw@2300 RPM
Electric Motors	2 x e-Motion Radial Flux Permanent Magnet Electric
Max speed	Up to 24 knots
Range at cruising speed	Up to 328nm
Displacement speed	10 knots

Performance figures are given in good faith. The loading of the vessel and fouling to the hull, as well as sea state will have an effect on performance. For these reasons we can give no guarantee on performance or range estimations.

HYBRID FEATURES

- Extended range for long distance passages at displacement speeds
- Silent running of 'Hotel' loads overnight and for short passages on battery power
- Reduced main engine running hours and CO2 emissions

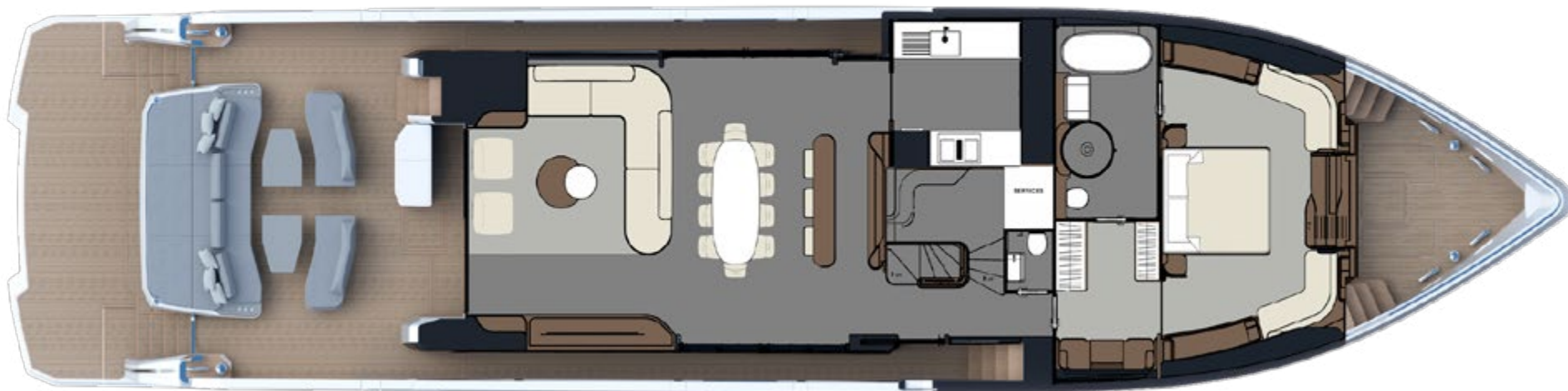

MAIN FEATURES

- RINA Classification Pleasure Type A (Hull and machinery)
- Twin MAN 2000 engines
- E-Motion hybrid system
- Raised Pilot House
- 5 guest cabins, including 2 master suites, large forward VIP, and 2 twin cabins
- Direct access from main deck master cabin to foredeck
- Crew accommodation for 4/5 with direct engine room access
- Garage capacity for Williams 445DJ and Sea-Doo Spark
- Spacious aft cockpit with fold-out wings
- Spacious flybridge deck with direct access to foredeck
- Dometic chilled water air conditioning system – 216,000 BTU
- H&B hydraulically operated bathing platform
- Integrated Garmin navigation system
- Teak laid cockpit, bathing platform, flybridge & side decks
- CMC trim interceptors with automatic list & trim assist
- CMC variable speed hydraulic bow thruster
- Interior design by Kelly Hoppen interiors
- Exterior design and naval architecture by Dixon Yacht Design
- 5 Year Warranty



CUSTOMER CARE

THE PEARL PROMISE

Nobody does more to support you on your journey to Pearl ownership and beyond. Whatever you need to make the most of your Pearl experience, we'll always be on hand to advise and inspire.

AFTERSALES & SERVICE

At Pearl, we believe that the same level of care and attention you received during the purchasing process should remain throughout time as an owner. It's an ethos that runs through everything we do. One that ensures you have access to the support of a Pearl agent wherever you and your yacht reside.

DELIVERY

Delivery of a Pearl yacht is a unique event. A moment as rewarding as the experiences you will encounter. From the build slot, to the delivery date, we do everything possible to ensure a seamless transfer of ownership. All we ask is that you only reserve your Pearl after you have experienced the model first hand during a sea trial or factory visit.

FINANCE

Our experts are available to make the journey to ownership even more accessible. By introducing you to finance houses such as Lombard Marine, you will have the freedom to discuss a tailored financial package that best reflects your situation.



5 YEAR WARRANTY

Each Pearl model benefits from an industry-leading comprehensive 5-Year Warranty, designed to safeguard your investment and give you absolute peace of mind long into the future.



...PEARL | GULF

sales@oceanworld.group

+971 52 404 2000