

  
OCEANWORLD  
YACHTS

  
Gulf



MANHATTAN 68



FILL THE HORIZON WITH THRILLING POSSIBILITIES.  
DEFINE THE MOMENT. RELAX. INDULGE. ENTERTAIN.  
DOMINATE THE SCENE WITH STYLE. THE PLACE  
TO BE FOR FAMILY AND FRIENDS. WHERE ADVENTURE  
NEVER SLEEPS.

## MANHATTAN 68

Basking in the latest innovations, the Manhattan 68 has one sole purpose. Effortless entertainment. With generous, flexible sociable spaces, it conjures up a feeling of being on board a much larger craft. With large sunbathing areas, a well-equipped wet-bar and a revolutionary aft Beach Club area, all typically reserved for larger boats; the Manhattan 68 is every inch the socialite.











## PRINCIPAL CHARACTERISTICS

**LENGTH OVERALL**  
21.21M / 67' 7"

**BEAM**  
5.26M / 17' 3"

**DRAFT**  
1.60 M / 5' 4"

**DISPLACEMENT**  
37,400 KG / 82,453 LB

**FUEL CAPACITY**  
4,000 LITRES / 1,057 US GAL.

**FRESH WATER CAPACITY**  
900 LITRES / 238 US GAL.

**BLACK WATER CAPACITY**  
200 LITRES / 53 US GAL.

**ACCOMMODATION**  
UP TO 8 GUESTS & UP TO 2 CREW

**ENGINE OPTIONS**  
MAN or VOLVO PENTA IPS UP TO 2,400 PS

**MAXIMUM SPEED**  
UP TO 32 KNOTS

**RANGE @ 10 KNOTS**  
UP TO 550 NAUTICAL MILES

**DRIVES**  
SHAFTS OR PODS



























































MANHATTAN 68  
GENERAL ARRANGEMENTS





MANHATTAN 68  
GENERAL ARRANGEMENTS

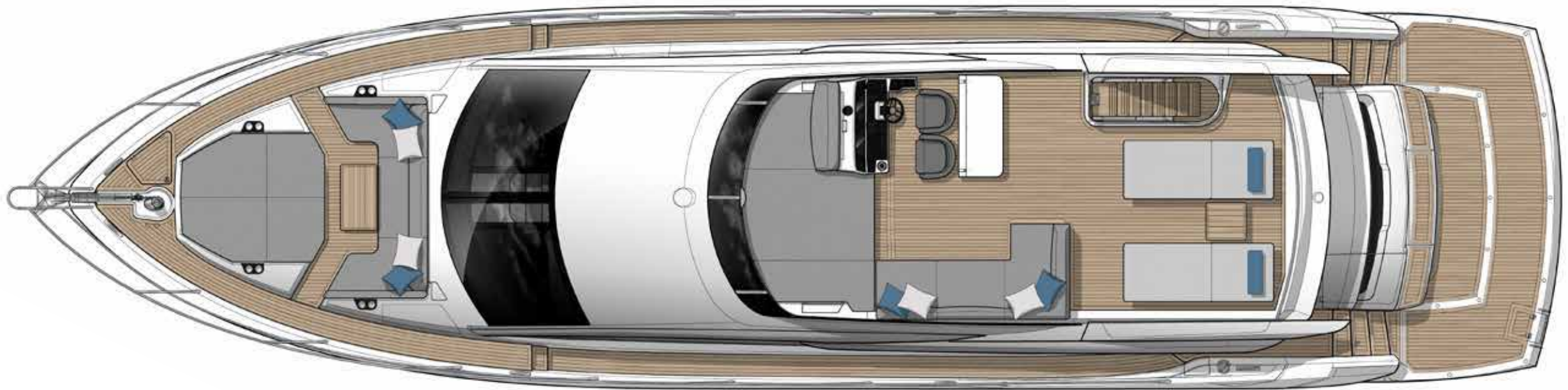

EXTERIOR PLAN



MANHATTAN 68  
GENERAL ARRANGEMENTS



MAIN DECK



MANHATTAN 68  
GENERAL ARRANGEMENTS

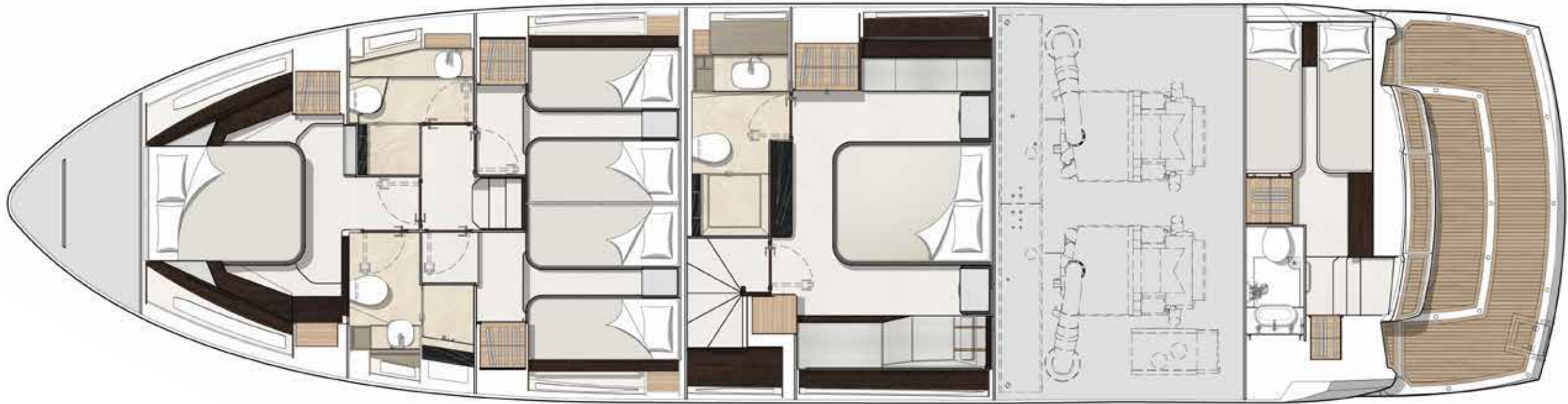

LOWER DECK





**[sales@oceanworld.group](mailto:sales@oceanworld.group)**

**+971 52 404 2000**